

Stainless Steel 3000 lb Threaded Fitting

S/S 316, 316L, 304, 304L

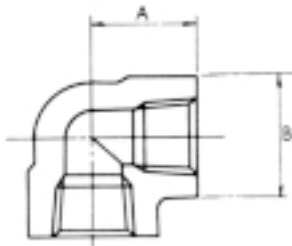

90° Elbow



SIZE	A	B
1/8	0.81	0.88
1/4	0.97	1.06
3/8	1.13	1.31
1/2	1.31	1.50
3/4	1.50	1.81
1	1.75	2.19
1-1/4	2.00	2.44
1-1/2	2.38	2.97
2	2.50	3.31
2-1/2	3.25	4.00
3	3.75	4.75

Unions

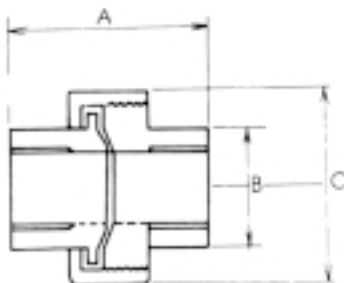

SIZE	A	B	C
1/8	1.63	0.88	1.38
1/4	1.63	0.88	1.38
3/8	1.81	1.03	1.63
1/2	1.94	1.25	1.84
3/4	2.25	1.47	2.19
1	2.50	1.63	2.50
1-1/4	2.81	2.03	3.06
1-1/2	3.00	2.31	3.41
2	3.38	2.84	4.09
2-1/2	4.39	3.90	4.89
3	4.69	4.53	5.75

Tee

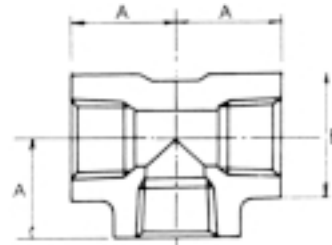

SIZE	A	B
1/8	0.81	0.88
1/4	0.97	1.06
3/8	1.13	1.31
1/2	1.31	1.50
3/4	1.50	1.81
1	1.75	2.19
1-1/4	2.00	2.44
1-1/2	2.38	2.97
2	2.50	3.31
2-1/2	3.25	4.00
3	3.75	4.75

Cross

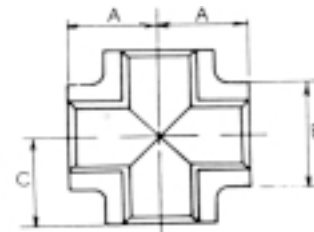

SIZE	A	B
1/8	0.81	0.88
1/4	0.97	1.06
3/8	1.13	1.31
1/2	1.31	1.50
3/4	1.50	1.81
1	1.75	2.19
1-1/4	2.00	2.44
1-1/2	2.38	2.97
2	2.50	3.31
2-1/2	3.25	4.00
3	3.75	4.75

45° Elbow

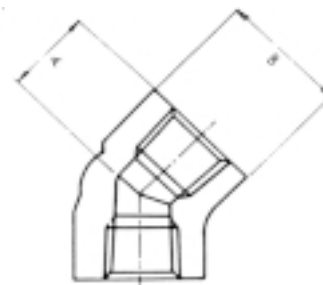

SIZE	A	B
1/8	0.69	0.88
1/4	0.75	1.06
3/8	0.88	1.31
1/2	1.00	1.50
3/4	1.13	1.81
1	1.31	2.19
1-1/4	1.38	2.44
1-1/2	1.69	2.97
2	1.72	3.31
2-1/2	2.06	4.00
3	2.50	4.75