

JIS 5K, 10K Flanges (Carbon Steel, Mild Steel, Stainless Steel (304, 304L, 316, 316L))

When ordering please State material size & type of flange

UNIT : mm

Nominal Diameter of Flange	Outside Diameter of Steel Pipe	Insertion Hole Diameter d_c	Outside Diameter of Flange D	Sectional Dimensions of Flange					Bolt Hole			Nominal Bolt Size	Weld Length (Reference)		Approx. Weight (kg/w)	
				t	T	Diameter of Hub		Radius r	Bolt Circle Diameter C	Number of Bolt Holes	Hole Diameter h		Nominal Bolt Size	W_1		W_2
						a	b									
10	17.3	17.8	75	9	-	-	-	-	55	4	12	M10	5	2.5	0.27	
15	21.7	22.2	80	9	-	-	-	-	60	4	12	M10	5	3	0.3	
20	27.2	27.7	85	10	-	-	-	-	65	4	12	M10	5	3	0.37	
25	34	34.5	95	10	-	-	-	-	75	4	12	M10	5	3	0.45	
32	42.7	43.2	115	12	-	-	-	-	90	4	15	M12	6	3	0.78	
40	48.6	49.1	120	12	-	-	-	-	95	4	15	M12	6	3	0.83	
50	60.5	61.1	130	14	-	-	-	-	105	4	15	M12	6	3	1.07	
65	76.3	77.1	155	14	-	-	-	-	130	4	15	M12	6	4	1.49	
80	89.1	90	180	14	-	-	-	-	145	4	19	M16	6	4	1.99	
(90)	101.6	102.6	190	14	-	-	-	-	155	4	19	M16	6	4	2.09	
100	114.3	115.4	200	16	-	-	-	-	165	8	19	M16	7	4	2.39	
125	139.8	141.2	235	16	-	-	-	-	200	8	19	M16	7	4	3.25	
150	165.2	166.6	265	18	-	-	-	-	230	8	19	M16	7	5	4.41	
(175)	190.7	192.1	300	18	-	-	-	-	260	8	23	M20	7.5	5	5.51	
200	216.3	218	320	20	-	-	-	-	290	8	23	M20	8.5	6	6.33	
(225)	241.8	243.7	345	20	-	-	-	-	305	12	23	M20	9	6	6.84	
250	267.4	269.5	385	22	-	-	-	-	345	12	23	M20	10	6	9.45	
300	318.5	321	430	22	-	-	-	-	390	12	23	M20	10	6	10.3	
350	355.6	358.1	480	24	-	-	-	-	435	12	25	M22	12	7	14	
400	406.4	409	540	24	-	-	-	-	495	16	25	M22	13	7	16.9	
450	457.2	460	605	24	40	485	500	5	595	16	25	M22	12	7	24.8	
500	508	511	655	24	40	546	552	5	605	20	25	M22	12	7	28.9	
550	558.8	562	720	26	42	587	603	5	665	20	27	M24	12	7	34.1	
600	609.6	613	770	26	44	648	654	5	715	20	27	M24	12	7	37.5	
650	660.4	664	825	26	48	702	708	5	770	24	27	M24	12	7	42.8	
700	711.2	715	875	26	48	751	758	5	820	24	27	M24	12	7	45.4	
750	762	766	945	28	52	802	810	5	880	24	33	M30	12	7	57.4	
800	812.8	817	995	28	52	854	862	5	930	24	33	M30	13	8	60.8	
(850)	863.6	868	1045	28	54	904	912	5	980	24	33	M30	13	8	63.5	
900	914.4	919	1095	30	56	956	964	5	1030	24	33	M30	13	8	75.3	
1000	1016	1021	1195	32	60	1058	1066	5	1130	28	33	M30	14	9	88.5	

Shape & Dimensions 5K

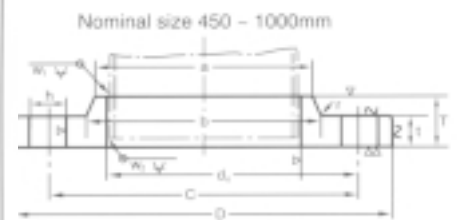
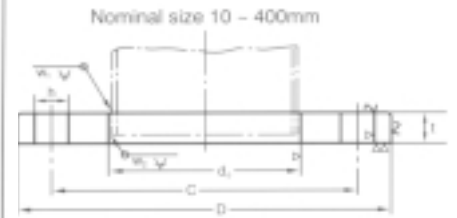

Nominal size 10 - 225, 250, 300mm

Nominal size 250 - 1000mm

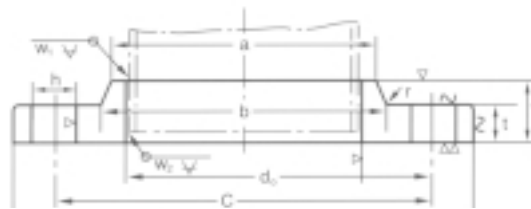

UNIT : mm

Dimensions 10K

Nominal Diameter of Flange	Outside Diameter of Steel Pipe	Insertion Hole Diameter d_c	Outside Diameter of Flange D	Sectional Dimensions of Flange					Bolt Hole			Nominal Bolt Size	Weld Length (Reference)		Approx. Weight (kg/w)	
				t	T	Diameter of Hub		Radius r	Bolt Circle Diameter C	Number of Bolt Holes	Hole Diameter h		Nominal Bolt Size	W_1		W_2
						a	b									
10	17.3	17.8	80	12	-	-	-	-	65	4	15	M12	5	2.5	0.52	
15	21.7	22.2	85	12	-	-	-	-	70	4	15	M12	5	3	0.57	
20	27.2	27.7	100	14	-	-	-	-	75	4	15	M12	5	3	0.73	
25	34	34.5	125	14	-	-	-	-	80	4	19	M16	5	3	1.13	
32	42.7	43.2	135	16	-	-	-	-	100	4	19	M16	6	3	1.46	
40	48.6	49.1	140	16	-	-	-	-	105	4	19	M16	6	3	1.56	
50	60.5	61.1	155	16	-	-	-	-	120	4	19	M16	6	3	1.88	
65	76.3	77.1	175	18	-	-	-	-	140	4	19	M16	6.5	4	2.6	
80	89.1	90	185	18	-	-	-	-	150	8	19	M16	6.5	4	2.61	
(90)	101.6	102.6	195	18	-	-	-	-	160	8	19	M16	6.5	4	2.76	
100	114.3	115.4	210	18	-	-	-	-	175	8	19	M16	7	4	3.14	
125	139.8	141.2	250	20	-	-	-	-	210	8	23	M20	7.5	4	4.77	
150	165.2	166.6	280	22	-	-	-	-	240	8	23	M20	8	5	6.34	
(175)	190.7	192.1	305	22	-	-	-	-	265	12	23	M20	9	5	6.82	
200	216.3	218	330	22	-	-	-	-	290	12	23	M20	9	6	7.53	
(225)	241.8	243.7	350	22	-	-	-	-	310	12	23	M20	9	6	7.74	
* 250	267.4	269.5	400	24	-	-	-	-	355	12	25	M22	10	6	11.8	
* 300	267.4	261.5	400	24	36	288	292	6	355	12	25	M22	10	6	12.7	
	318.5	321	445	26	-	-	-	-	400	16	25	M22	10	6	13.6	
	318.5	321	445	24	38	340	346	6	400	16	25	M22	10	6	13.8	
350	355.6	358	490	26	42	380	386	6	445	16	25	M22	12	7	18.2	
400	406.4	409	560	28	44	436	442	6	510	16	27	M24	12	7	25.2	
450	457.2	460	620	30	48	496	502	6	565	20	27	M24	14	8	33	
500	508	511	675	30	48	548	554	6	620	20	27	M24	14	8	37.6	
550	558.8	562	745	32	52	604	610	6	680	20	33	M30	15	9	49.7	
600	609.6	613	795	32	52	656	662	6	730	24	33	M30	16	10	52.6	
650	660.4	664	845	34	56	706	712	6	780	24	33	M30	16	10	60.6	
700	711.2	715	905	34	58	762	770	6	840	24	33	M30	17	10	70.6	
750	762	766	970	36	62	816	824	6	900	24	33	M30	18	11	85.8	
800	812.8	817	1020	36	64	868	876	6	950	28	33	M30	19	12	91.2	
(850)	863.6	868	1070	36	66	920	928	6	1000	28	33	M30	19	12	98.6	
900	914.4	919	1120	38	70	971	979	6	1050	28	33	M30	22	14	109	
1000	1016	1021	1225	40	74	1073	1081	6	1180	28	39	M36	22	14	133	

A Wide Range of Flanges

150 lb Ansi Flange

Material: Mild Steel, Carbon Steel, Stainless Steel 316, 316L, 304, 304L
When ordering please State material & type of flange



WELDING NECK



LAP JOINT



BLIND



SLIP-ON



SCREWED



SOCKET WELDING

THREADED

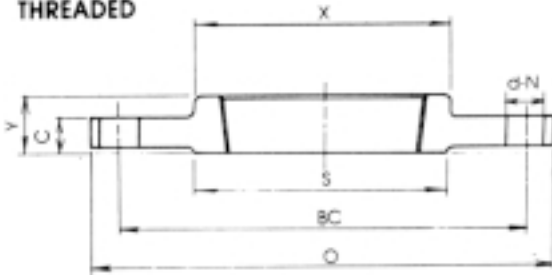

SLIP-ON

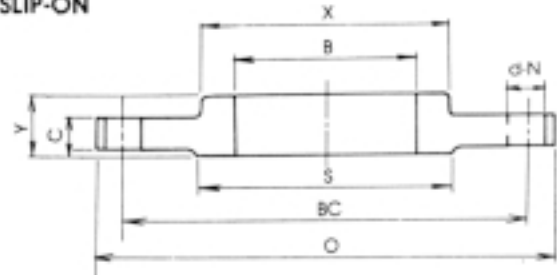

SOCKET-WELDING

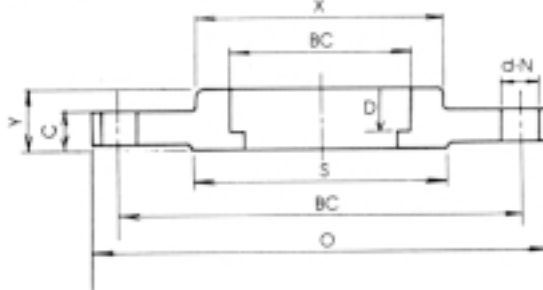

LAP-JOINT

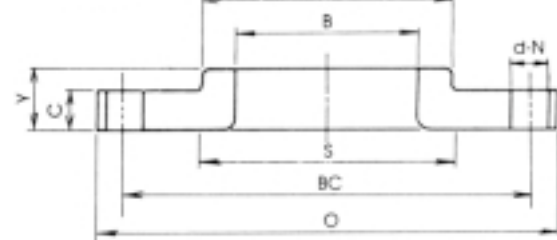

BLIND

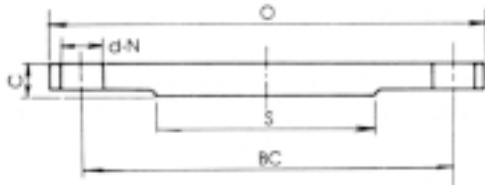

WELD NECK

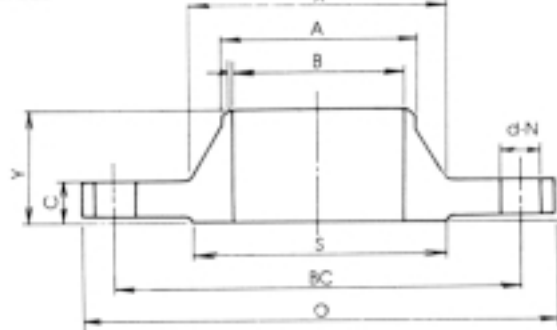

UNIT: INCH

SIZE	O	S	X	A	B			Y		C	BC	d	N	D	r
					Socket Welding Slip-On Welding	Lap Joint	Welding Neck	Welding Neck	(Except) Welding Neck						
1/2	3.50	1.38	1.19	0.84	0.89	0.92	0.62	1.87	0.63	0.45	2.38	0.62	4	0.39	0.12
3/4	3.86	1.69	1.50	1.05	1.11	1.13	0.82	2.06	0.63	0.51	2.75	0.62	4	0.43	0.12
1	4.25	2.00	1.94	1.32	1.38	1.39	1.05	2.19	0.67	0.57	3.12	0.62	4	0.51	0.12
1-1/4	4.61	2.50	2.31	1.66	1.72	1.74	1.38	2.25	0.83	0.63	3.50	0.62	4	0.55	0.20
1-1/2	5.00	2.87	2.56	1.90	1.97	1.98	1.61	2.44	0.87	0.69	3.87	0.62	4	0.63	0.24
2	5.98	3.63	3.06	2.38	2.46	2.48	2.07	2.50	0.98	0.77	4.75	0.75	4	0.67	0.31
2-1/2	7.01	4.13	3.56	2.87	2.96	2.98	2.47	2.75	1.14	0.89	5.50	0.75	4	0.75	0.31
3	7.50	5.00	4.25	3.50	3.59	3.61	3.07	2.75	1.18	0.94	6.00	0.75	4	0.83	0.39
3-1/2	8.50	5.50	4.81	4.00	4.08	4.11	3.55	2.81	1.26	0.94	7.00	0.75	8	0.87	0.39
4	9.02	6.19	5.31	4.50	4.59	4.61	4.03	3.00	1.30	0.94	7.50	0.75	8	0.94	0.43
5	10.00	7.31	6.44	5.56	5.68	5.70	5.05	3.50	1.42	0.94	8.50	0.87	8	0.98	0.43
6	10.98	8.50	7.56	6.63	6.74	6.76	6.07	3.50	1.57	1.00	9.50	0.87	8	1.06	0.51
8	13.50	10.63	9.69	8.63	8.74	8.76	7.98	4.00	1.73	1.14	11.75	0.87	8	1.14	0.51
10	15.98	12.75	12.00	10.75	10.90	10.94	10.01	4.00	1.93	1.20	14.25	1.00	12		0.51
12	19.02	15.00	14.37	12.75	12.89	12.93	12.00	4.50	2.20	1.26	17.00	1.00	12		0.51

300 lb Ansi Flange

Material: Mild Steel, Carbon Steel, Stainless Steel 316, 316L, 304, 304L

When ordering please State material & type of flange



WELDING NECK



LAP JOINT



BLIND



SLIP-ON



SCREWED



SOCKET WELDING

THREADED

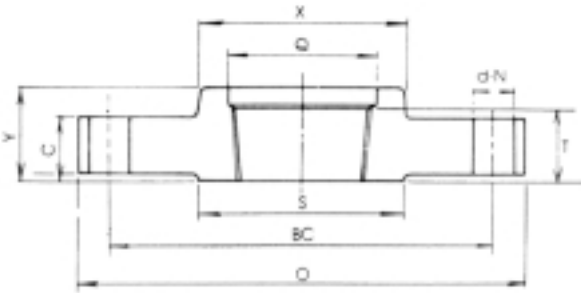

SLIP-ON

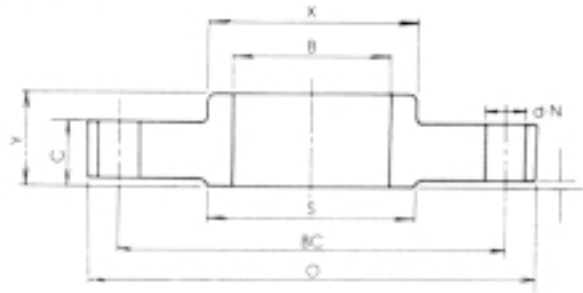

SOCKET-WELDING

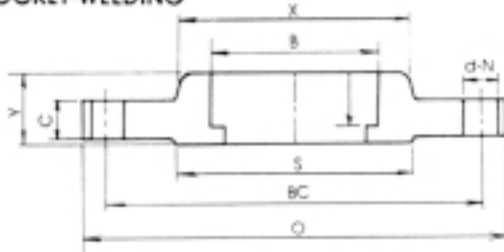

LAP-JOINT

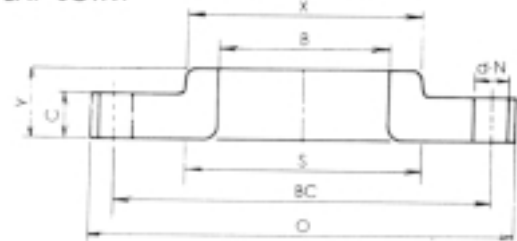

BLIND

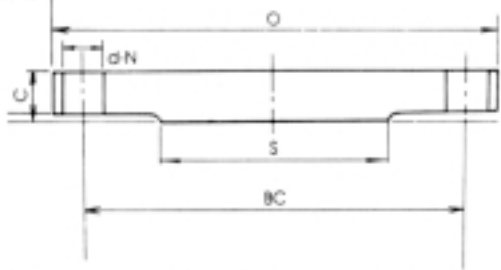

WELD NECK

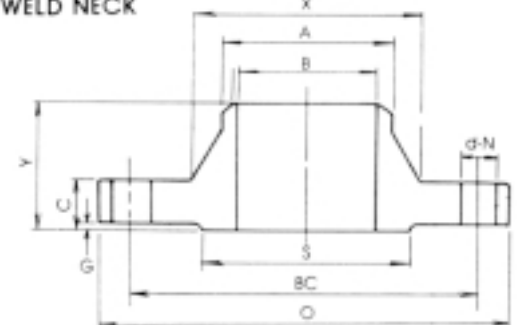

UNIT: INCH

SIZE	O	S	X	A	B			Q	Y		C	G	T	BC	d	N	r
					Socket Welding Slip-On Welding	Lap Joint	Welding Neck		Welding Neck	[Except] Welding Neck							
1/2	3.74	1.38	1.50	0.84	0.89	0.92	0.62	0.93	2.06	0.87	0.57	0.06	0.63	2.63	0.62	4	0.12
3/4	4.61	1.69	1.87	1.05	1.11	1.13	0.82	1.14	2.25	0.98	0.63	0.06	0.63	3.25	0.75	4	0.12
1	4.88	2.00	2.12	1.32	1.38	1.39	1.05	1.42	2.44	1.06	0.69	0.06	0.69	3.50	0.75	4	0.12
1-1/4	5.24	2.50	2.50	1.66	1.72	1.74	1.38	1.75	2.56	1.06	0.77	0.06	0.81	3.87	0.75	4	0.20
1-1/2	6.14	2.87	2.75	1.90	1.97	1.98	1.61	1.99	2.69	1.18	0.83	0.06	0.87	4.50	0.87	4	0.24
2	6.50	3.63	3.31	2.38	2.46	2.48	2.07	2.50	2.75	1.30	0.89	0.06	1.13	5.00	0.75	8	0.31
2-1/2	7.52	4.13	3.94	2.87	2.96	2.98	2.47	2.99	3.00	1.50	1.00	0.06	1.25	5.87	0.87	8	0.31
3	8.27	5.00	4.63	3.50	3.57	3.61	3.07	3.62	3.13	1.69	1.14	0.06	1.25	6.63	0.87	8	0.39
3-1/2	9.02	5.50	5.25	4.00	4.08	4.11	3.55	4.13	3.19	1.73	1.20	0.06	1.44	7.24	0.87	8	0.39
4	10.00	6.19	5.75	4.50	4.59	4.61	4.03	4.65	3.37	1.90	1.26	0.06	1.44	7.87	0.87	8	0.43
5	10.98	7.31	7.00	5.56	5.68	5.70	5.05	5.71	3.87	2.01	1.38	0.06	1.69	9.25	0.87	8	0.43
6	12.52	8.50	8.12	6.63	6.74	6.76	6.07	6.73	3.87	2.05	1.46	0.06	1.81	10.63	0.87	12	0.51
8	15.00	10.63	10.25	8.63	8.74	8.76	7.98	8.74	4.37	2.44	1.63	0.06	2.00	13.00	1.00	12	0.51
10	17.52	12.75	12.63	10.75	10.90	10.94	10.02	10.87	4.63	2.64	1.89	0.06	2.19	15.25	1.12	16	0.51
12	20.47	15.00	14.75	12.95	12.89	12.93	12.00	12.95	5.13	2.87	2.01	0.06	2.38	17.75	1.25	16	0.51