

Gravity Feed Glass Oiler

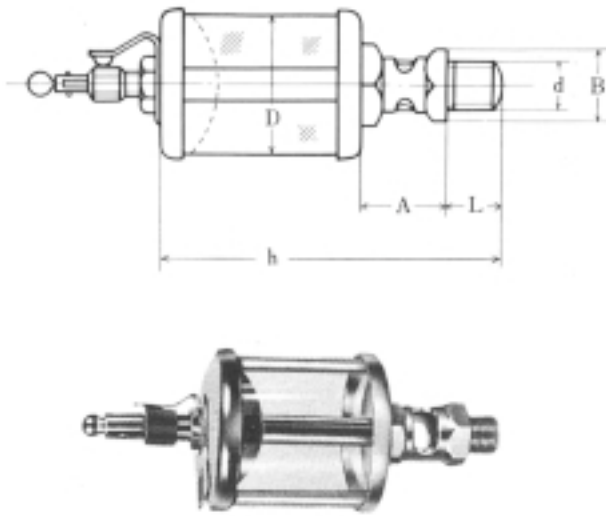

P/No.	Size (% x PF)	Port Size		D	h	A	L	Across the Flat B
		d	No. of threads					
601	20 x 3/8	3/8	28	20	50	16	8	13
602	25 x 3/8	3/8	28	25	55	16	8	13
603	32 x 3/8	3/8	28	32	70	22	10	16
604	32 x 1/4	1/4	19	32	70	22	10	16
605	38 x 3/8	3/8	28	38	77	22	10	16
606	38 x 1/4	1/4	19	38	77	22	10	16
607	38 x 3/8	3/8	19	38	80	22	13	18
608	50 x 3/8	3/8	19	50	98	28	12	19
609	50 x 3/8	3/8	19	50	100	28	14	19
610	50 x 1/2	1/2	14	50	104	30	16	23
611	65 x 1/4	1/4	19	65	113	28	12	19
612	65 x 3/8	3/8	19	65	115	28	14	19
613	65 x 1/2	1/2	14	65	119	30	16	23
614	75 x 1/4	1/4	19	75	122	28	12	19
615	75 x 3/8	3/8	19	75	122	28	14	19
616	75 x 1/2	1/2	14	75	126	30	16	23
617	100 x 3/8	3/8	19	100	160	35	16	27
618	100 x 1/2	1/2	14	100	160	35	16	27
619	100 x 3/4	3/4	14	100	160	35	16	27

Oil Sight Gauge

Unit : mm

P/No.	Size % x PF	Port Size		Length Glass	A	C	L	D	F	h	Nut	
		d	No. of threads								Across the Flat B	T
701	50 x 3/8	3/8	28	52	30	15	15	13	30	65	14	4
702	65 x 3/8	3/8	28	67	30	15	15	13	45	80	14	4
703	75 x 3/8	3/8	28	77	30	15	15	13	55	90	14	4
704	100 x 3/8	3/8	28	102	30	15	15	13	75	115	14	4
705	125 x 3/8	3/8	28	127	30	15	15	13	100	140	14	4
706	150 x 3/8	3/8	28	152	30	15	15	13	125	165	14	4
722	200 x 3/8	3/8	19	202	38	19	19	13	170	220	19	7
723	250 x 3/8	3/8	19	252	38	19	19	13	220	270	19	7
724	300 x 3/8	3/8	19	302	38	19	19	13	270	320	19	7

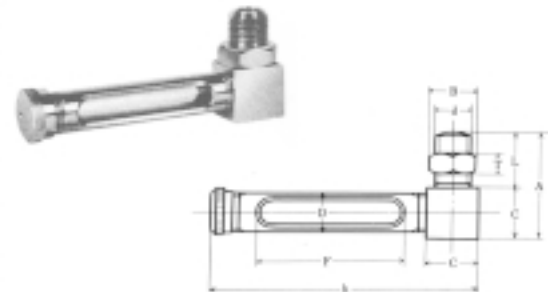

Oil Cup

Unit : mm

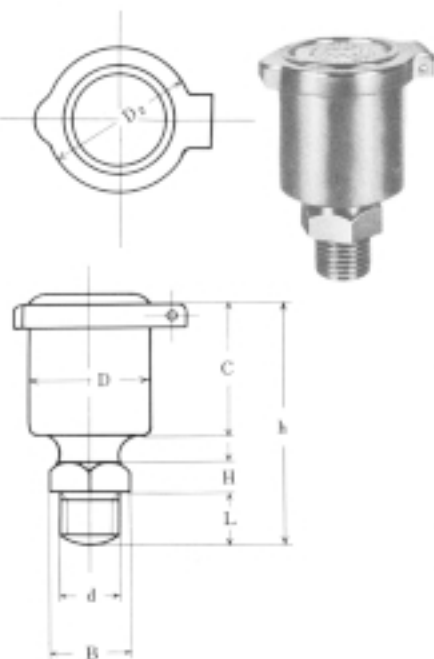

P/No.	Size (% x PF)	DIMENSIONS								
		D	Port Size		h	C	L	H	Across the Flat	D ₂
			d	No. of threads						
501	18 x 1/8	18	1/8	28	38	21	8	5	12	22
502	22 x 1/8	22	1/8	28	42	25	8	5	12	25
503	22 x 1/4	22	1/4	19	47	25	11	6	14	25
504	28 x 1/8	28	1/8	28	52	31	10	6	14	32
505	28 x 1/4	28	1/4	19	52	31	11	6	17	32
506	34 x 1/8	34	1/8	28	60	35	11	8	17	32
507	34 x 1/4	34	1/4	19	60	35	12	8	17	38
508	34 x 3/8	34	3/8	19	61	35	13	8	19	38
509	45 x 1/4	45	1/4	19	75	47	14	9	19	50
510	45 x 3/8	45	3/8	19	75	47	14	9	19	50
511	45 x 1/2	45	1/2	14	79	47	16	10	24	50