

Cast Iron Valve Flange End, Swing Check, Y-Strainer, Butterfly, Gate Valve



Swing Check Valve

150WOG Oil, Gas, Water
100 psi steam
Size: 2", 2 1/2", 3", 4",
5", 6", 8", 10".
Flange Standard,
10K, 150 lb



Class 125 Gate Valve

Bolted bonnet, outside
screw & yoke, rising stem,
solid wedge disc.
200 psi-WOG
125 psi stem
Size: 2", 2 1/2", 3", 4",
5", 6", 8", 10".

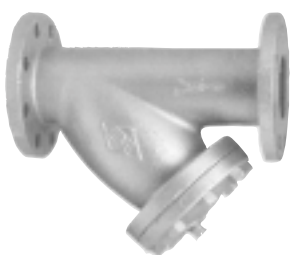

Y-Type Strainer

Bolted cover, Y-pattern
body, Punched stainless
steel plate screen.
60°C WOG-14kgf/cm²
Steam-7kgf/cm²
Size: 2", 2 1/2", 3", 4",
5", 6", 8".



Class 100 Gate Valve

Bolted bonnet, inside
screw, non-rising stem,
solid wedge disc.
150 psi-WOG
100 psi stem
Size: 2", 2 1/2", 3", 4",
5", 6".



10K Butterfly

Water type lever handle
120°C WOG 14kgf/cm²
WOG 10kgf/cm²
Size: 2", 2 1/2", 3", 4",
5", 6", 8", 10", 12".



10K Globe Valve

Bolted bonnet, outside
screw & yoke, rising stem,
bevelled wedge disc.
150 psi-WOG
100 psi stem
Size: 2", 2 1/2", 3", 4", 5",
6", 8".



Class 125 Gate Valve

Bolted bonnet, inside
screw, non-rising stem,
solid disc.
WOG-200 psi
Steam-125 psi
Size: 2", 2 1/2", 3", 4",
5", 6", 8", 10", 12".



Class 150 Bronze Angle Valve

Inside screw, Angle type
body, Rising stem,
Screwed bonnet, Threaded
ends to BS21 or NPT.
300psi-WOG
Material: Bronze
Size: 3/8", 1/2", 3/4", 1",
1 1/4", 1 1/2", 2".